



Allied Aluminum Rigid Local Stock

7500 Intervale Avenue Detroit, MI 48238



Contact Christy Cafarelli for Pricing and Product Questions: christy@ycesales.com or (313) 491-6500



Aluminum Rigid Conduit (ARC)				
Trade Size	Outside Diameter	Wall Thickness	Weight Per 100 ft.	Qty in Master Bundle
1/2"	0.840"	0.104"	28lbs	2500'
3/4"	1.050"	0.107"	37lbs	2500'
1"	1.315"	0.126"	55lbs	2000'
1-1/4"	1.660"	0.133"	72lbs	1000'
1-1/2"	1.900"	0.138"	89lbs	1000'
2"	2.375"	0.146"	119lbs	450'
2-1/2"	2.875"	0.193"	188lbs	300'
3"	3.500"	0.205"	246lbs	200'
3-1/2"	4.000"	0.215"	296lbs	200'
4"	4.500"	0.225"	350lbs	200'
5"	5.563"	0.245"	479lbs	80'
6"	6.625"	0.266"	635lbs	60'



Aluminum Rigid Couplings					
Trade Size	Outside Dims (A)	Min Length (B)	Threads Per in.	Weight Per 100 Pc	Standard Package
1/2"	1.078"	1-5/8"	14	6lbs	100
3/4"	1.328"	1 41/64"	14	9lbs	50
1"	1.562"	1 31/32"	11 1/2	13lbs	30
1 1/4"	1.953"	2 1/32"	11 1/2	19lbs	25
1 1/2"	2.219"	2 1/16"	11 1/2	23lbs	25
2"	2.750"	2 1/8"	11 1/2	35lbs	15
2 1/2"	3.281"	3 3/16"	8	68lbs	20
3"	3.812"	3 5/16"	8	91lbs	15
3 1/2"	4.438"	3 13/32"	8	108lbs	12
4"	5.000"	3 33/64"	8	142lbs	12
5"	6.219"	3 61/64"	8	242lbs	8
6"	7.312"	4 1/4"	8	320lbs	6

Aluminum Rigid 90 Degree Elbows					
Trade Size	Dims Radius (A)	Dims Offset (B)	Dims Straight	Weight Per 100 Pc	Standard Package
1/2	4"	5-7/8"	1-1/2"	22lbs	25
3/4	4-1/2"	7"	1-1/2"	32lbs	40
1	5-3/4"	8-3/4"	1-7/8"	62lbs	25
1 1/4	7-1/4"	10-1/2"	2"	99lbs	10
1 1/2	8-1/4"	11-3/4"	2"	137lbs	10
2	9-1/2"	14-1/2"	2"	228lbs	5
2 1/2	10-1/2"	17-1/4"	3"	427lbs	80
3	13"	22-3/4"	3-1/8"	752lbs	50
3 1/2	15"	23-1/4"	3-1/4"	889lbs	50
4	16"	23-3/8"	3-3/8"	1049lbs	36
5	24"	34-7/8"	3-5/8"	2125lbs	1
6	30"	45-1/2"	3-3/4"	3738lbs	1

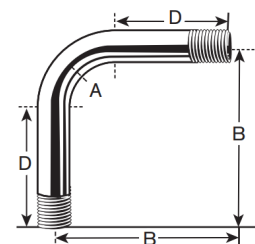
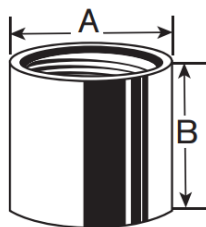

Min Order \$100
 Freight Allowed \$2,000
 Will Break Bundles